

- LEGEND**
- DRAINAGE CREEK
  - UNDEVELOPED SPACE
  - OPEN SPACE
  - ON SITE DETENTION AREA
  - INITIAL CITY OF CONROE ACCEPTANCE BOND
  - CANCELLATION OF MAINTENANCE BOND
  - MONTGOMERY COUNTY MUNICIPAL UTILITY DISTRICT #407 BOUNDARY
  - PLAT BOUNDARY

**GRAYSTONE HILLS STREET ACCEPTANCE STATUS**

PROJECT	INITIAL CITY ACCEPTANCE	CANCELLATION OF MAINTENANCE BOND
GRAYSTONE HILLS SECTION 1 / PARK BLVD.	01/24/2007	01/3/2008
GRAYSTONE HILLS SECTION 2	01/24/2007	01/3/2008
GRAYSTONE HILLS SECTION 3	08/7/2007	8/14/2008
GRAYSTONE HILLS SECTION 4	9/25/2008	11/16/2009
GRAYSTONE HILLS SECTION 5	3/19/2008	6/22/2009
GRAYSTONE HILLS SECTION 6	2/18/2008	3/24/2009
GRAYSTONE HILLS SECTION 7	6/17/2008	7/14/2009
GRAYSTONE HILLS SECTION 8	2/18/2008	3/10/2009
GRAYSTONE HILLS SECTION 9	1/8/2009	2/18/2010
GRAYSTONE HILLS SECTION 10	7/8/2009	6/17/2010
AARON PASTERNAK DRIVE	6/8/2009	6/17/2010
NORTH WHITE OAK BLVD.	1/29/2011	3/12/2012
GRAYSTONE HILLS SECTION 11		
GRAYSTONE HILLS SECTION 12	5/11/2011	PENDING
GRAYSTONE HILLS SECTION 13		
GRAYSTONE HILLS SECTION 14		
GRAYSTONE HILLS SECTION 15		

**GRAYSTONE HILLS PLATTING STATUS**

PROJECT	PRELIMINARY PLAT	RECORDED PLAT	RECORDED INFO.
	ACRES	LOTS	CABINET SHEET(S)
GRAYSTONE HILLS SECTION 1	31.1389	60	407/408
GRAYSTONE HILLS SECTION 2	21.4206	67	405/406
GRAYSTONE HILLS SECTION 3	16.1469	58	578/579
GRAYSTONE HILLS SECTION 4	19.8182	46	778/779
GRAYSTONE HILLS SECTION 5	16.3606	48	788/789
GRAYSTONE HILLS SECTION 6	16.1616	50	845/846
GRAYSTONE HILLS SECTION 7	18.8396	19	864/865
GRAYSTONE HILLS SECTION 8	11.7944	32	968/969
GRAYSTONE HILLS SECTION 9	17.7840	42	1008/1009
GRAYSTONE HILLS SECTION 10	15.9498	49	1628/1629
AARON PASTERNAK DRIVE	1.6520	N/A	1625-1627
GRAYSTONE HILLS SECTION 11	12.44	46	
GRAYSTONE HILLS SECTION 12	17.44	41	
GRAYSTONE HILLS SECTION 13	12.0963	42	1952/1953
GRAYSTONE HILLS SECTION 14	7.9148	18	2127/2128
GRAYSTONE HILLS SECTION 15	17.34	51	
TOTAL	47.22	138	207.08 531

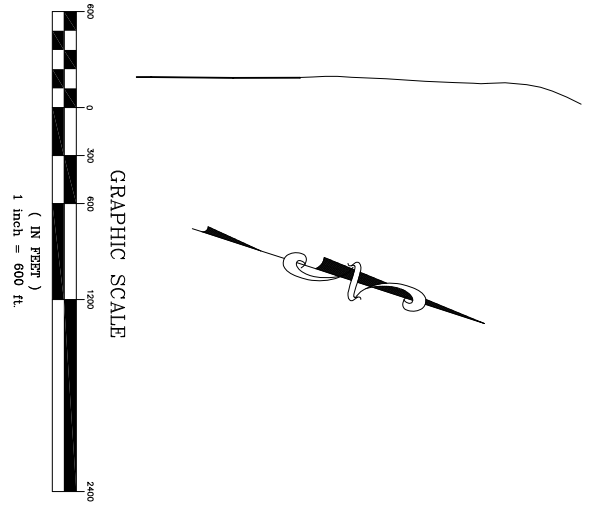
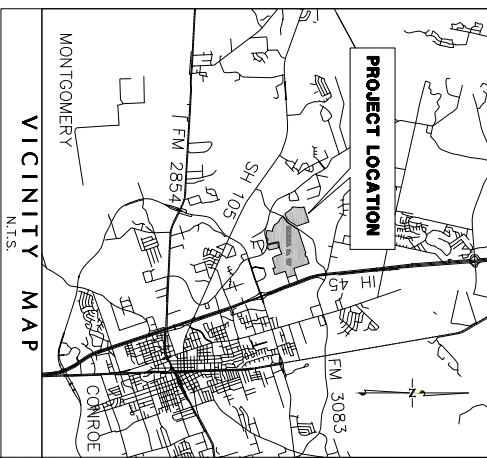
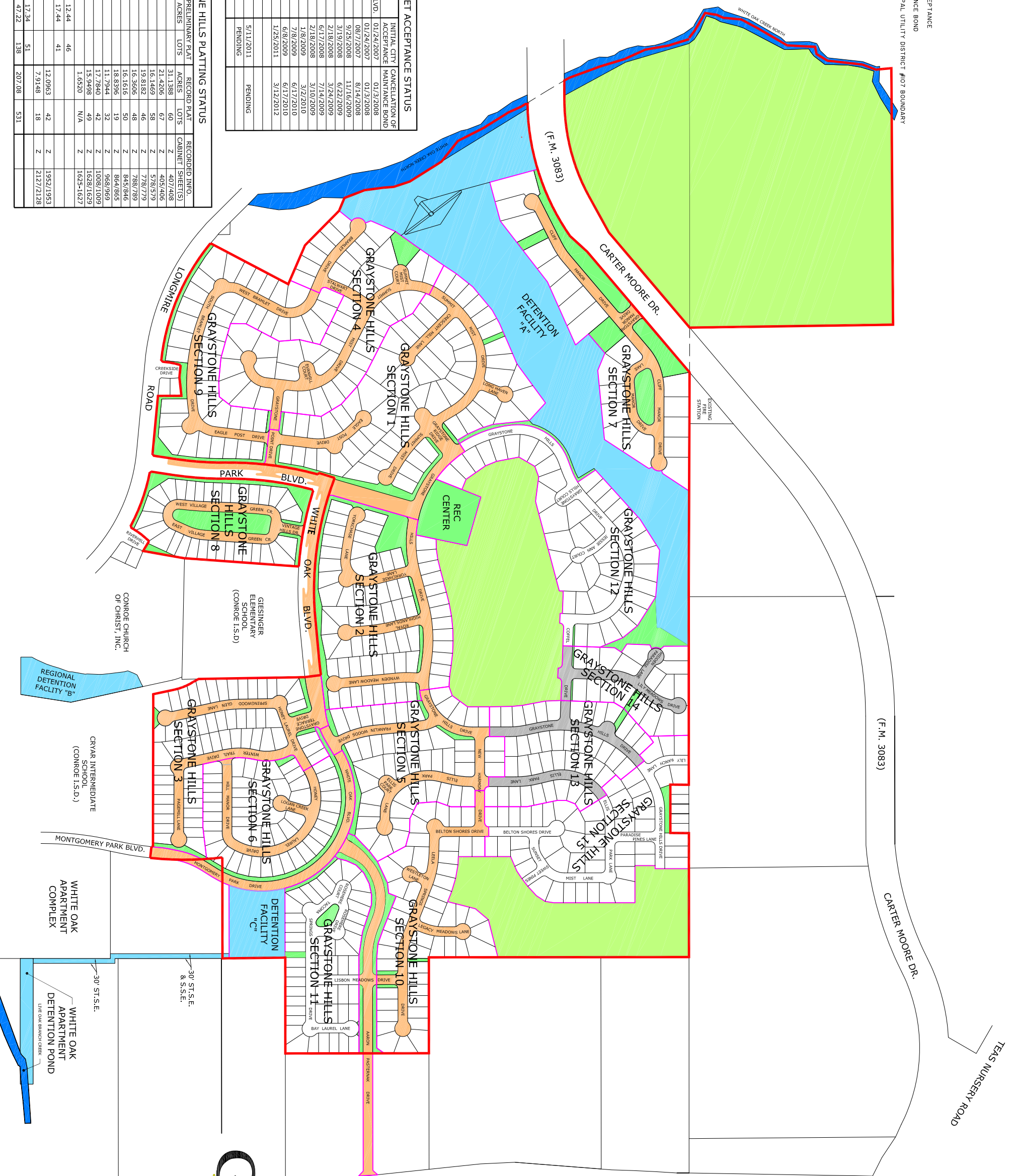

INTERSTATE HIGHWAY 45

**GRAYSTONE HILLS**

**JACOBS**  
 JACOBS ENGINEERING GROUP, INC.  
 5995 ROGERDALE ROAD  
 HOUSTON, TEXAS 77072  
 832.351.1600 FAX 281.776.2170

DISCLAIMER: THIS MAP IS SUBJECT TO FURTHER REVISIONS AND REVISIONS SHOULD NOT BE RELIED UPON AS RECORD OR PRELIMINARY INSTRUMENTS.

THIS MAP WAS PREPARED THROUGH BENEFIT OF A TITLE REPORT AND IS INTENDED FOR GENERAL PLANNING AND INFORMATIONAL PURPOSES ONLY. IT IS ISSUED SOLELY FOR INFORMATIONAL PURPOSES AND DOES NOT CONSTITUTE AN OFFER OF ANY SERVICE. THE ENGINEER HAS MADE NO INDEPENDENT SEARCH, EXAMINATION OR ATTEMPT TO ASCERTAIN THE ACCURACY OF ANY INFORMATION OR OPINION AS TO THE COMPLETENESS, FAIRNESS, OBJECTIVITY AND RELIABILITY OF THE INFORMATION PROVIDED HEREON.

UPDATED: APRIL, 2012